



Station Level Paging Adapter

Model 300PBX-SC

LINKS TELEPHONE TO SELECTONE® OR PUBLIC ADDRESS SYSTEM

- Paging by calling a dedicated extension
- Powered by a phone line connection
- Type 1 enclosure
- FCC Approved

The 300PBX-SC telephone system interface allows access from a PABX (Private Automatic Branch Exchange) to a SelectTone® system or centrally amplified paging system. A single standard RJ11 modular jack is the only input required.

The 300PBX-SC is assigned a dedicated line in place of a telephone. By dialing the extension to which the 300PBX-SC is connected, direct paging access is made to the SelectTone command unit. When the connection is made, a tone is sounded both in the phone and the SelectTone® speaker amplifiers. The 300PBX-SC will automatically disconnect when the dial tone is heard or after the pre-determined time limit has expired.

The Model 300PBX-SC includes both an audio output and a double-throw relay circuit to activate the music mute or other function during page. The audio output is a 600 ohm balanced line for direct connection to an audio amplifier. A high impedance output with level adjust is also provided. The controls can adjust the Alert Tone Level, Paging Access Time, Dial Tone Sensitivity and Dial Tone Trip Time.

The cadmium-plated housing can be mounted to most surfaces by means of a #6 screw through the holes in the mounting flanges.

Federal Signal's 300PBX-SC Station Level Paging Adapter saves money by linking an existing phone system to a public address system or SelectTone system.



STATION LEVEL PAGE ADAPTER (300PBX-SC)

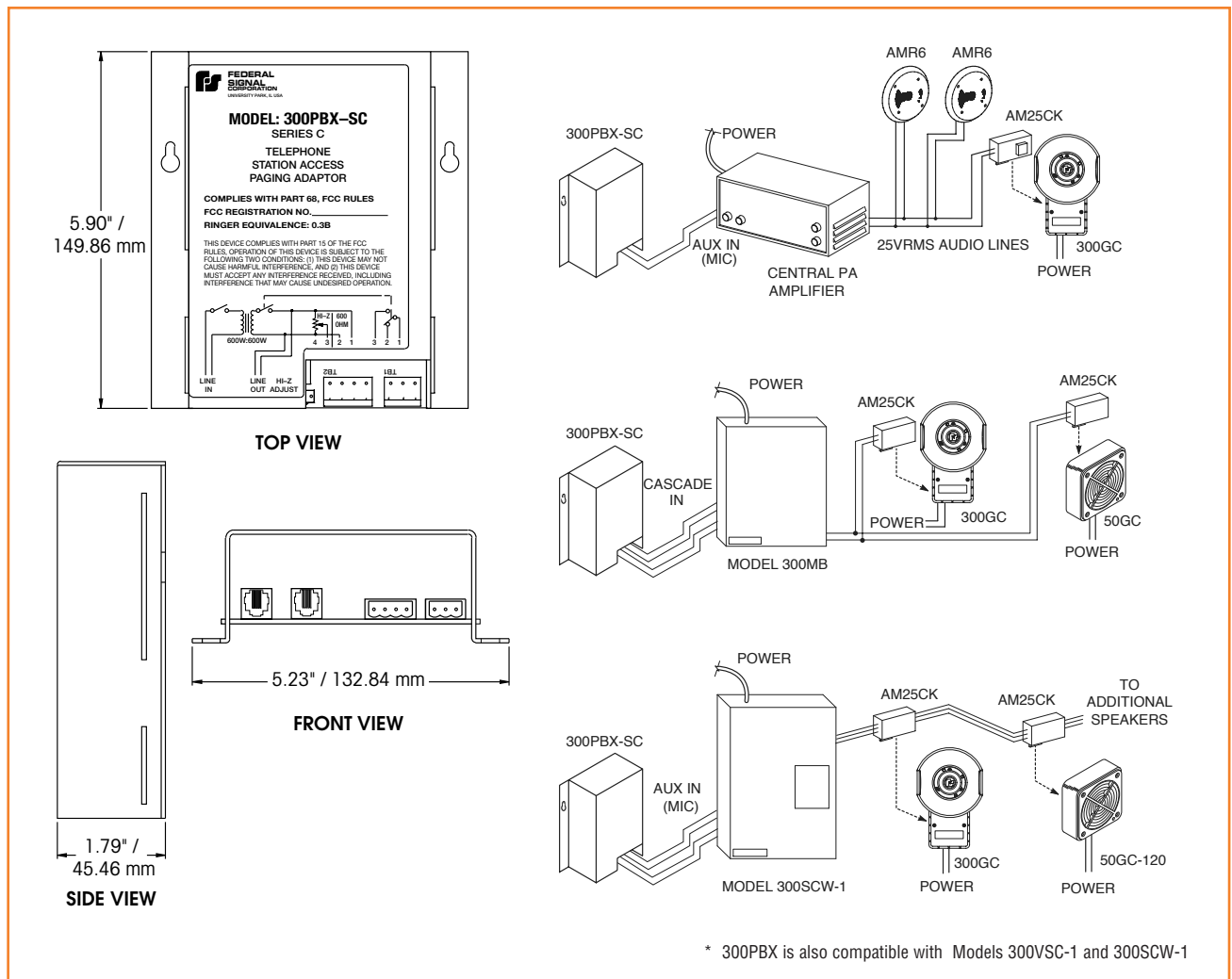

SPECIFICATIONS

Input:

Connector:	RJ-11 or RJ-13
Ringer Equivalence:	1.3 B
Ring Detection:	15.3 Hz to 68 Hz @ 40-150 V
Loop Current:	90mA max
Alert Tone Frequency:	600Hz
Dial Tone Frequency:	350Hz
Page Access Time:	5 to 30 seconds
Shipping Weight:	2.0 lbs. 0.9 kg
Height:	6.125" 15.6 cm
Width:	3.0" 7.6 cm
Depth:	1.25" 3.2 cm

Output:

Connector:	RCA Unbalanced Screw Terminals
Impedance:	Hi-Z (22W min.) 600W
Level:	-5.0 dB w/ internal termination -0.5 dB no termination
Relay Ratings:	SPDT, 1A contacts
Controls:	Output Levels, Alert Tone Level Dial Tone Sensitivity, Dial Tone, Trip Delay, Page Access Time

HOW TO ORDER

- Specify model number
- Please refer to Model Number Index 300PBX-SC beginning on page 377