

Corrosion Resistant Zone 1 Loudspeaker

Model P-LS2B and P-LS2C



Shown with swivel mounting bracket

FOR USE IN MARINE AND HAZARDOUS APPLICATIONS

- Corrosion-resistant Anti-Static GRP (Glass-Reinforced Polyester) Design
- Universal Mounting Bracket
- Stainless-Steel Hardware
- CE Compliant
- ATEX/IEC Zone 1 Gas Groups IIB and IIC
- Ingress rated IP66

Federal Signal's corrosion resistant loudspeakers, model P-LS2B and P-LS2C, are designed for use in industrial public address and general alarm applications, where corrosion resistance and ATEX/IEC Certification are required. P-LS2B and P-LS2C loudspeakers are available in an ATEX/IEC Zone 1 explosion-proof version certified IP66 for ingress of dust and combustible gas to either Group IIB or Group IIC.

P-LS2B and P-LS2C loudspeakers, designed to accept an audio input of 100 Vrms, are manufactured from corrosion-resistant, anti-static glass-reinforced polyester (GRP). Each speaker is transformer coupled with a maximum power output of 25 watts and is supplied with 10 preset taps (25, 20, 15, 10, 5, 2, 1.5, 1, 0.5 and 0.2 watts) to adjust sound output.

Mounting is provided by a "common template" stainless-steel ratcheted mounting bracket that locks the sounder in position at a specific angle without slipping. The bottom surface of the mounting bracket also contains four slotted mounting holes to further adjust speaker position and adapt to a variety of different surfaces.

Connection for field wiring is provided by two M20 X 1.5 mm threaded openings in the bottom of the rear cover and terminated via internal terminal blocks. All external hardware is manufactured from stainless steel to resist corrosion and provide serviceability for years to come.

ATEX IEC CE

Model	Power Handling	Frequency Response	Power Transformer	Taps	Decibels @	
					10'	1m
P-LS2B	25 watt	350 - 14kHz	100 Vrms	20, 15, 10, 5, 2 1.5, 1, 0.5, 0.2	114	124
P-LS2C	25watt	350 - 14kHz	100 Vrms	20, 15, 10, 5, 2 1.5, 1, 0.5, 0.2	113	123



CORROSION RESISTANT ZONE 1 LOUDSPEAKER (P-LS2B AND P-LS2C)

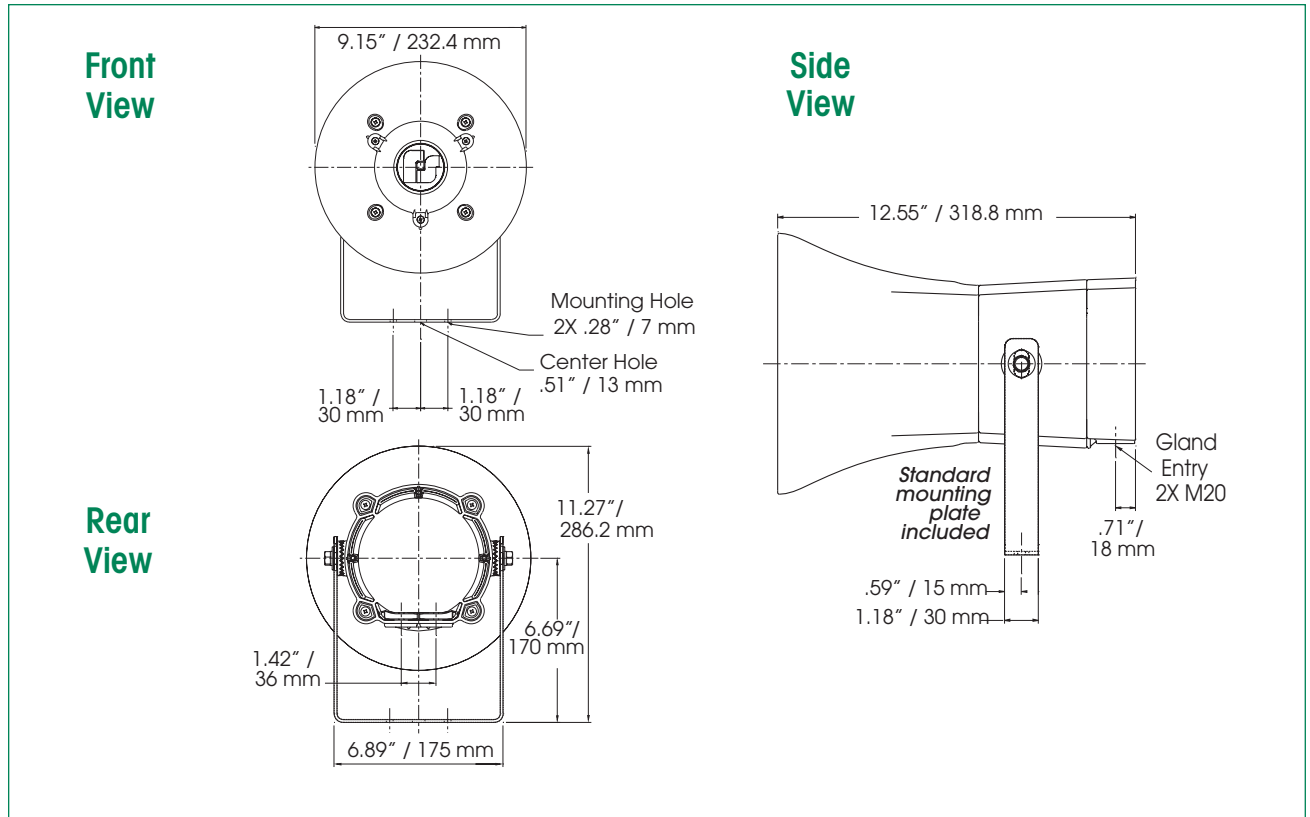

SPECIFICATIONS

Certificate Number:

ATEX	Baseefa10ATEX0096X
IECEX	IECEX BAS 10.0052X
P-LS2B	CE 0539 Ex II 2G
	Ex d e mb IIB + H2 T5 Gb (-50°C ≤ Ta +70°C)
	T6 Gb (-50°C ≤ Ta +55°C)
P-LS2C	CE 0539 Ex II 2GD
	Ex d e mb IIC T5 Gb Ex tb IIIC IP66 T100°C Db (-50°C ≤ Ta +70°C)
	T6 Gb Ex tb IIIC IP66 T85°C Db (-50°C ≤ Ta +55°C)

Gland Entries: 2 X M20 X 1.5 mm

Cable Terminations: 0.5 – 4 mm² (12-22 AWG) Conductors

Size (P-LS2B & P-LS2C):

232.4 mm	(9.15") Diameter
286.2 mm	(11.27") Height
318.8 mm	(12.55") Length

Material: Glass-Reinforced Polyester (GRP)

Color: Black

Audio Input: 100 Vrms

Audio Output (Peak): (max.) 124dB @ 25 watts (1 meter)

Frequency Response: 350 – 14kHz

Net Weight: (P-LS2B & P-LS2C): 5.9 kg 13.0 lbs

Shipping Weight: (P-LS2B & P-LS2C): 6.9 kg 15.3 lbs

HOW TO ORDER

- Specify model and voltage
Corrosion Resistant Loudspeaker,
ATEX Zone 1 Rated Gas Group 2B (P-LS2B)
Corrosion Resistant Loudspeaker,
ATEX Zone 1 Rated Gas Group 2C (P-LS2C)
- Optional Accessories
Swivel Mounting Bracket (K8595172A)

REPLACEMENT PARTS

Description	Part Number
Standard Mounting Bracket	K8595171
Swivel Mounting Bracket	K8595172A
Ratchet Fixing Kit	K8595194
Bracket Mounting Screws	K7002086-16
Outer Horn	K8595150
Rear Cover	K8595153
Rear Cover Gasket Kit	K8595195
Fuse Module	K8595177